

Bombardier Global XRS



Price set to make offer

Airframe Status:

Current as of: 3/1/2010
Total Time: 2978 hrs. (est)
Total Landings: 500 ldgs. (est)
Registration: HB-JGY (Switzerland)
Aircraft Model: BD-700-1A10 (Global XRS)
Date of Manufacture: 24. May 2005
In Service since: 01. May 2006

Engine Status:

Engine Model: BR700-710A2-20
Engine 1 S/N: 12439 TSN/CSN: 1573 / 610 cycl. (est)
Engine 2 S/N: 12294 TSN/CSN: 2910 / 780 cycl. (est)

APU Status:

APU Model: RE-220GX
APU S/N: P-276 TSN/CSN: 2000 hrs. / 1200 cycl. (est)

Maintenance tracking program: CAMP

Operation approval/equipment:

Commercial JAR/EU-OPS 1, RVSM, B-RNAV, NAT-MNPS, RNP, FM
Immunity, 8.33 MHz., Mode S
EHS, ACAS II, EGPWS, 406 MHz ELT.

Certification:

TCDS EASA.IM.A.009, JAR/EU OPS-1 Subpart K & L, MTOM 98'000
lbs., 51'000ft Max Operation
Altitude

Commercial Programs enrolled since new: Nil

Equipment / Configuration /Modification Status Highlights:

- 3rd. FMS
- HUD
- EVS
- Dual HF system
- 3rd. VHF COM
- 14 pax interior
- 1 Flight observer seat
- 1 F/A, Fwd. Crew Rest Area/Seat
- 2 x 3 Place Divan
- Fwd. Crew Lavatory
- Global 5000 Viscofoam single seats with armrest monitors
- 2ea. CMC EFB's
- 3ea. Multi Region Dual DVD Players
- Permanent installed PMAT
- 2 Cabin Bulkhead Monitors
- 4 Place Conference Group
- Mechanical Hi-Low double pedestal table
- Manual Cabin Pocket Doors
- Airshow Systems
- Galley Microwave and Hi-Temp Oven
- 115 VAC cabin outlet
- FDR QAR installed

Remarks:

- _ Previous Bombardier Demo Aircraft
- _ Partial exterior repaint c/w March 2008
- _ Partial interior refurbishment incl new seats c/w March 2008
- _ New cabin carpet
- _ Electric window shades
- _ Latest Rockwell Collins CES software installation mid 2009
- _ Life rafts conform to JAR Ops-1 operation

Interior:

- Galley on right hand side in entrance area, Crew Lavatory on right hand side in entrance area, Food Tray carrier in left forward crew cabinet.
- Crew Rest Compartment on L/H side at entrance area.
- Seating for 14 passengers (Forward cabin zone: 4 single club seats; Mid cabin zone: one conference group on the left hand side and a 1 single club seat on the right hand side; Aft cabin zone: two 3 place divan on each side.
- Mid and Aft Cabin divided by manual pocket door.
- "Office in Sky" System installed (Iridium and AeroH+).
- Entertainment Equipment Systems: Two 18" LCD monitors installed (1 each fwd rh and aft lh mounted at the bulkheads. Three (3) DVD's; fourteen (14) headsets; stereo speaker system; 115VAC power outlets including galley, cabin and lavatory;
- Galley including: Microwave oven, Nespresso Maker, 115VAC power outlet, sink with hot and cold water, storage boxes for drinks, work surface table, ice storage, thermos storage, galley control panel, trash container.
- The fwd and aft lavatory incorporates vacuum toilet, sink with hot and cold water and 115VAC power outlet.

Interior OPTIONAL:

- Bombardier Global XRS Airshow System.
- Electrical Window Shades
- 2 Life rafts equipped with an ELT (Emergency Locator Transmitter) of 406 MHz.

Exterior:

- Overall fuselage color white (Matterhorn white I1070) with one dark blue stripe (Gloss Blue P296C) and one Gold stripe (Gloss Gold met IM0971).

Avionics Equipment OPTIONAL:

- RAAS
- 3rd. FMS

Incorporated Service Bulletins:

- Complete List will be provided on request

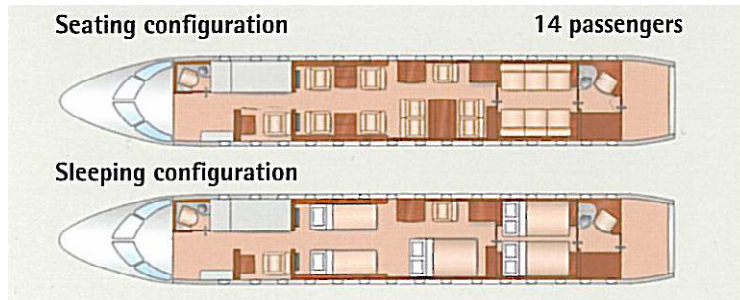

FWD cabin club seating (looking fwd)



MID cabin conference group (looking fwd)



Mid cabin conference group (looking aft)



AFT cabin (looking fwd)



Lavatory (aft)



Galley

DATA SUBJECT TO CHANGE